





Rochdale Road, Shaw

£125,000

 2  1  2



- No Chain
- High Crompton Location
- Walking Distance to Local Schools
- Two Bedrooms
- Extended Kitchen
- Two Reception Rooms
- Valliant Combination Boiler
- EPC:



NO CHAIN. Offered for sale is this two bedroom terraced property located in this popular spot in High Crompton. Both primary and secondary schools are within a short walking distance. Motorway networks and the local Metro station within easy access. Accommodation comprising: Entrance vestibule, lounge, dining area and a kitchen. To the first floor are two bedrooms and a bathroom. Externally is an open plan outside space and on road parking. Call us today to arrange a viewing.

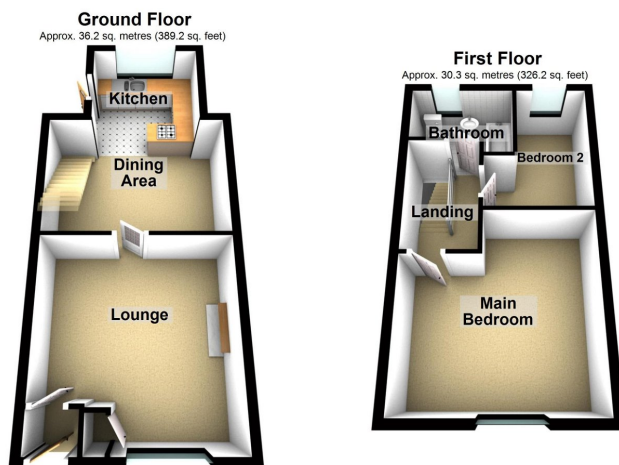

Total area: approx. 66.5 sq. metres (715.4 sq. feet)

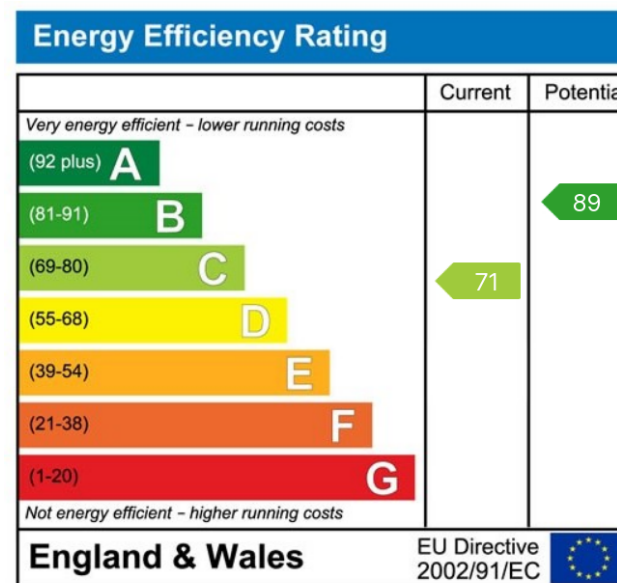

Chadderton Office

509 Middleton Road,
Chadderton, Oldham,
OL9 9SH

chadderton@kirkham-property.co.uk
t: 0161 626 5688